

SPECIALTY POWER WINDOWS

5559-2CVR 1955-59 CHEVROLET TRUCK ONE PIECE GLASS KIT FACTORY VENT REMOVED

Make sure that the glass template fits your opening properly before having the glass cut. You can determine this by using the template to do a cardboard cut out. Insert the cardboard cut out into your glass opening after the run channel has been installed. Adjust the template as needed. Follow instructions below.

Remove the inner door handle, window crank handle, and trim pad or upper panel.

Remove the vent window assembly and window regulator.

Remove door glass.

Cut access hole and remove the lower glass stop from inside the door.

Drill holes A, B, C, and D at locations shown on drawing. Holes C and D are 5/16". Drill a 5/16" hole at locations A and B through both panels. Redrill the outer panel at A and B with a 7/8" hole saw.

Cut a relief hole for the switches where the crank stems used to protrude through (if this is where you are going to mount the switches). Install the plastic edge guard (provided) on the edges of these holes to prevent possible electrical shorting.

Place the power regulator into the door and bolt in at locations A, B, C. The studs for attaching the lift bar assembly will point towards the outer panel of the door.

Install the flexible run channel in the rear door channel and the glass opening. See drawing for the part number that should be available through your local glass shop. This channel can be glued in with silicone or urethane. The front portion of the channel will hang down into the door for now. We will install the front guide channel later

Place the lower glass channel onto the bottom of the glass that has been cut per the provided template. Wrap the bottom edge of the glass with the glass sealing tape provided. The cloth side goes outward toward the channel. Hold the sealing tape in place with three or four pieces of masking tape. Hammer the channel onto the bottom edge of the glass. Make sure it is centered.

Assemble lift bar assembly and attach to the regulator with the acorn nuts so that the unit can pivot.

Install the front guide channel. The tab at the top of the channel slides in between the double panels at the base of the front pillar. You may have to separate the panels slightly with a screw driver. Do not secure the bottom of the channel at this time. It will have to be loose to install the glass.

Install the glass into the door. Attach it to the lift bar assembly.

Secure the front guide channel with the 1/4" x 1/2" bolt provided in hole D.

The regulator will have to be adjusted up and down and the front guide channel will have to be adjusted front to rear for proper operation. The glass will travel up slightly unlevel. When it reaches the top it will pivot into location for a good seal.

Test the operation with the motor test lead provided. Connect one lead to negative and one lead to positive for one direction. Reverse the leads for the opposite direction. **Use a fully charged 12 volt automotive batter. Do not use a battery charger.**

Install the FWC (flexible wire conduits) at the location shown on photo. Drill a 3/4" hole in the Hinge / Cowl Pillar for the small rubber grommet to fit into for the holding of the conduit spring. This hole will have to be in perfect alignment with the hole that will be in the door. You can do your alignment with your pilot hole. Drill your pilot hole all the way through and into the door with the door shut. Spray the grommet and spring with Windex and twist while pushing the spring into the grommet. The spring should extend through the grommet about 1/2" Drill a 15/16" hole in the front edge of the door. This hole is for the nylatron bushing. Place the bushing into the hole and place the large grommet over the backside of the bushing from the inside of the door. This will keep the bushing from pulling out. With the door open, bend the spring and insert it into the bushing. It should slide in and out of the bushing smoothly as you open and close the door.

Install and connect the wiring harness per the drawing. Cut the switch mounting holes so that the switch will fit snugly and the spring ears will hold it into place. Use the switch for a template. Make sure that the switch does not rub the inner panel.

Specialty Power Windows
140 Industrial Park Drive
P.O. Box 1486
Forsyth, GA 31029
478-994-9248 (Tech: 1:30 - 4:30 EST)



SPECIALTY POWER WINDOWS

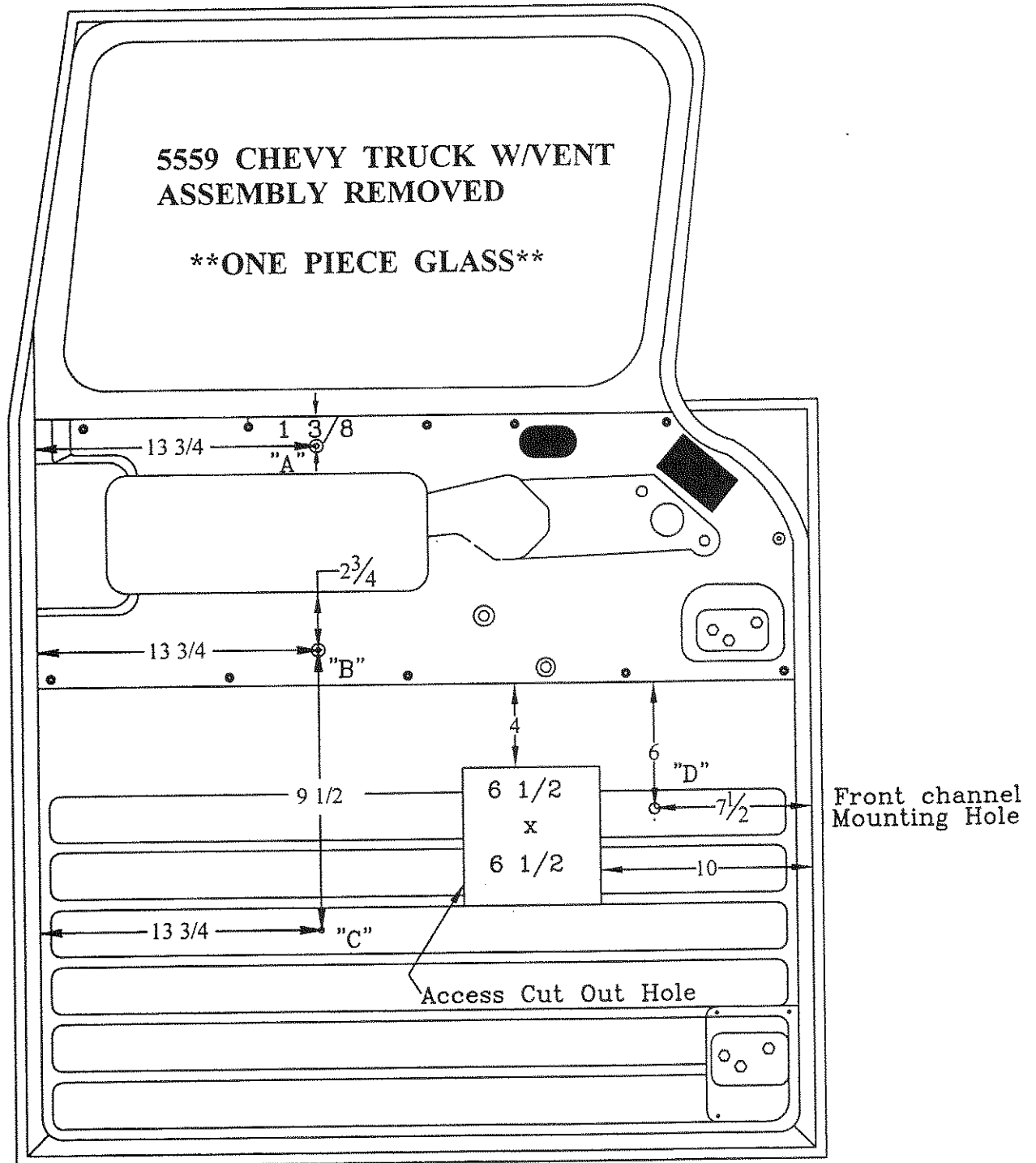

Universal Flexible Run Channels C.R. Laurence PN# 10M110

5559-2CVR

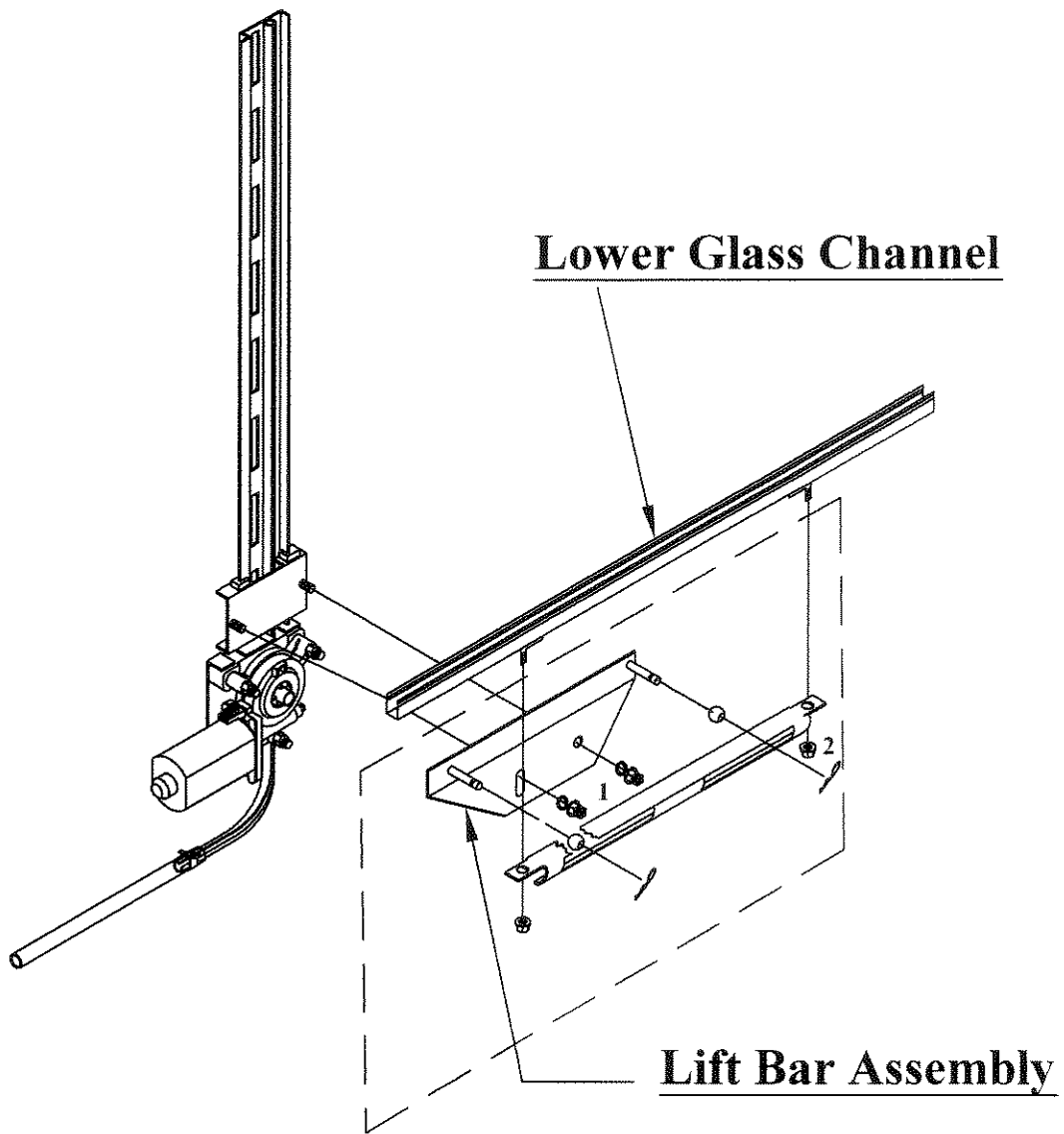

1- Acorn Nut

2- Flanged Nut

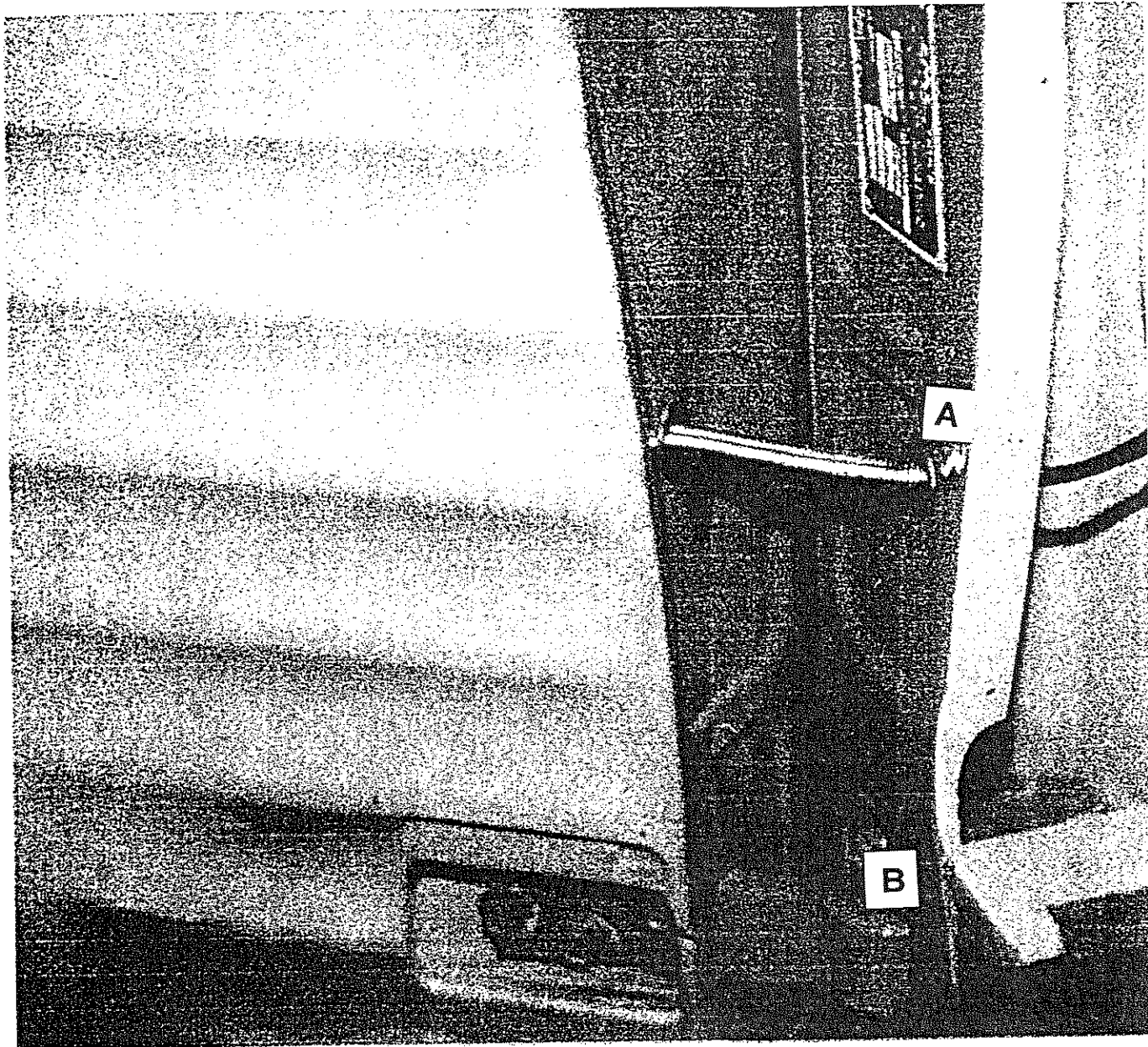

INSTALLING FWC

The hole in the pillar for the small rubber grommet should be located as follows:

1 5/8" from edge of pillar to center (see A above).

8" from top of hinge strap to center (see B above).